



# Precision Linear Pack

**THK** General Catalog

## B Product Specifications

Dimensional Drawing, Dimensional Table  
 Model ER ..... B-476

## A Technical Descriptions of the Products (Separate)

<b>Features</b> .....	A-566
Features of the Precision Linear Pack .	A-566
• Structure and features .....	A-566
Rated Load and Nominal Life.....	A-567
Accuracy Standards .....	A-569
Radial Clearance.....	A-569
<b>Precautions on Use</b> .....	A-570

\* Please see the separate "A Technical Descriptions of the Products".

# Model ER

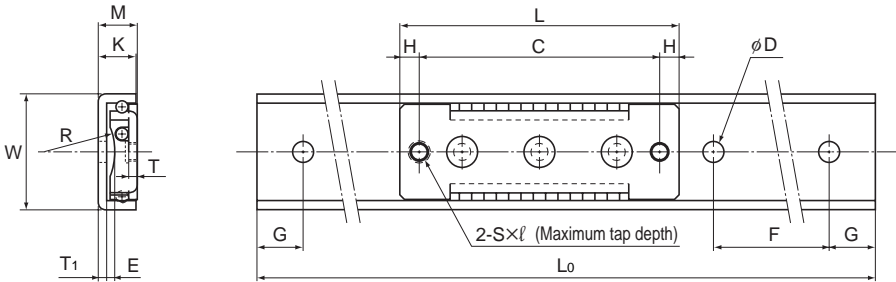

Model No.	Inner block dimensions									
	Width	Height	Length						Maximum tap depth	
	W	M $\pm 0.05$	L	C	H	E	R	S	l	T
ER 513	13	4.5	22	7	7.5	1.1	4.2	M2	1.3	0.9
ER 616	15.6	6	36	29	3.5	1.7	9.2	M3	1.8	1.1
ER 920	20	8.5	46	40	3	2.3	7.3	M3	2.5	1.9
ER 1025	25	10	56	48	4	2.9	9.3	M4	2.8	2.2

## Model number coding

**2 ER616 C1 +95L**

| Model number | Outer rail length (in mm)  
 | Radial clearance symbol (\*1)  
 | Number of inner blocks used on the same rail

(\*1) See A-569.

Unit: mm

Outer rail dimensions							Basic load rating		Mass	
K	T <sub>1</sub>	D	L <sub>0</sub>	F	G	C N	C <sub>0</sub> N	Inner block g	Outer rail g/m	
4	1.1	2.4	40, 60, 80	20	10	54.9	72.5	2.4	166	
5.5	1.4	2.9	45, 70, 95	25	10	71.6	125	5.6	268	
7.5	1.9	3.5	50, 80, 110	30	10	144	201	14.4	474	
9	2.2	4.5	60, 100, 140	40	10	215	315	27	677	

Note) To fix the outer rail of models ER513 and ER616, use cross-recessed screws for precision equipment (No. 0 screw).

Model No.	Type	Nominal name of screw × pitch
ER 513	No. 0 pan-head screw (class 1)	M2×0.4
ER 616		M2.6×0.45

Japan Camera Industry Association Standard JCIS 10-70  
Cross-recessed screw for precision equipment (No. 0 screw)

